

## PRODUCTS OVERVIEW

- Standard offering in 1045 Carbon Steel
- Features CR3 plating exceeding industry standards at 240hrs to Red Rust
- JIC, O-Ring Boss, NPT Connections
- Straights, Elbows, Tees, Crosses
- Caps, Plugs, Nuts
- Manufactured in accordance to SAE J514 Spec

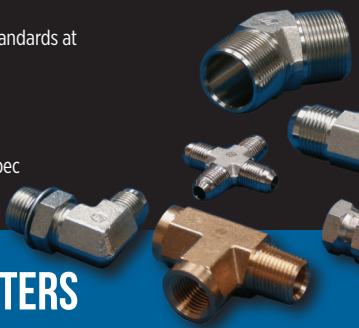

### TUBE FITTINGS & ADAPTERS

- Material in Carbon Steel, Nickel Plated Carbon, and Stainless Steel
- Buna-N and Viton O-Ring Seals available
- Straights, Elbows, Tees, Crosses
- Caps, Plugs, Nuts, and Braze-ons.
- Dove-tail groove design to keep O-ring in seat.



### ORFS PRODUCTS

- Code 61 and Code 62 Flanges to JIC, SAE, & ORFS connections.
- Featuring Single Piece Swept Tube or Forged Elbow Styles
- Plug Blocks & Plates
- Split & Captive Flanges
- Imperial and Metric Mounting Bolt Kits

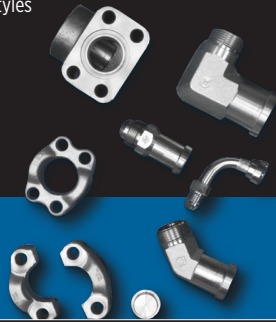

### FLANGE PRODUCTS

- Stainless Material options include 304/316L/316-Ti
- Huge inventory of SS finished parts and raw material for quick domestic turnaround
- JIC, NPT, ORB, ORFS, Flange, BSP, Metric, Compression, and more all available in Stainless



### STAINLESS STEEL PRODUCTS

- Wide selection of styles and configurations.
- Convenient when converting from British Parallel/Tapered, Metric, JIS, or Komatsu to JIC, ORFS, SAE, or NPT.
- Growing product segment with recent acquisitions of Truflo and Miric Engineering

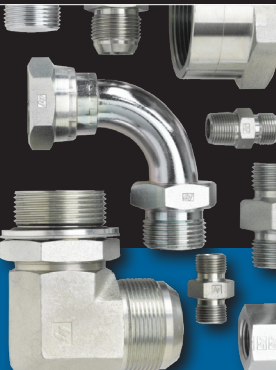

### INTERNATIONAL PRODUCTS

- Brennan's leading product category in SS
- Double Ferrule and Single Ferrule Fittings and Valves
- Interchangeable and Intermixable with Parker and Swagelok Brands
- Certified to ASTM F 1387
- Available standard in 316SS and Brass
- Size 1/8" to 1"

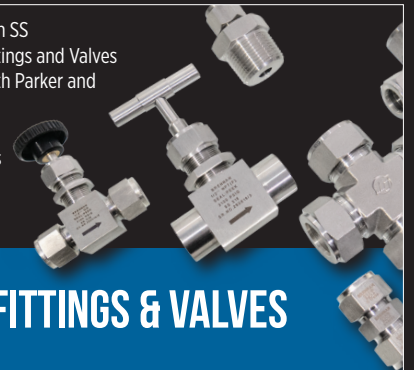

### INSTRUMENTATION FITTINGS & VALVES

- Offered in 1.4571 (316Ti) for extreme high level or corrosion and acid resistance
- Carbon Steel -Zinc Nickel Coating w/ over 1,000h resistance to white rust.
- Commonly used in Marine, Railway, Agg, Pulp and Paper and more.



### DIN PRODUCTS

- Push to Connect, Brass DOT- in accordance to DOT Standard 571.106
- Push to Connect, Nickel Plated Brass- in accordance to ISO 14743-2004
- Push to Connect, Nylon in accordance to ISO 14743-2004



### PUSH TO CONNECT PRODUCTS

## PRODUCTS OVERVIEW (CONTINUED)

- Convenient for retail counters and on-site locations.
- Kits come in Face-Seal, JIC, O-Ring Boss, NPT, DIN Light/Heavy, and BSP.



### CAP & PLUG KITS

- Most essential components for pressure checking
- Available in 1, 2, or 3 gauges
- Custom kits available



### TEST POINT KITS

- In accordance to SAE J 512
- Brennan's JIC/NPT/SAE line commonly stocked in Brass.
- High forged and low pressures extruded brass lines available.
- Push-On Hose Fittings offered in 1/4"-1" Hose
- Brass DOT line-up coming soon. Reach out for pricing and availability



### BRASS PRODUCTS

- 2-piece Stainless Steel Design
- Offered for True Bore Hose
- Connections to Imperial and DIN/Metric and BSP are available.
- Crimp specs for most major manufacturers

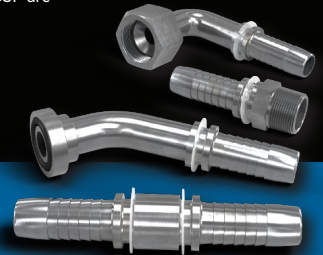

### HOSE FITTINGS

- Standard Series Clamps - up to 4" O.D
- Heavy Series Clamps - up to 5" O.D
- Twin Series Clamps - up to 1.65" O.D
- Available in Complete Kits or Individual Components
- 304 and 316 Stainless Steel
- Zinc Nickel or Unplated Carbon Steel also stocked
- Wide range of P-Clamp size



### CLAMP PRODUCTS



### HAM-LET & VERSA

## EXTRAORDINARY VALUE



### Availability

- 13 fully stocked distribution centers worldwide
- Widest selection of fittings and adapters in the industry.
- Commitment to inventory and ability to reserve stock for partnered distributors
- Engineered Specials



### Quality

- Controlled manufacturing locations across the globe.
- Products built to same master print.
- Standard plating which exceeds industry standards.
- Full traceability through batch coding.
- BI Verify to ensure correct order fulfillment.



### Support

- Global CSR team
- Educational materials (blog, whitepapers, Brennan University)
- Thread Identification tools
- Lead generation
- Literature
- Pressure rating, cross reference, and CAD tools



### Innovation

- New e-commerce system with live inventory information
- BI Verify
- Bridge Server
- Proprietary Brennan Black™ corrosion resistant coating